



INSPIRED BY THE LEGENDARY CRETAN HOSPITALITY.





# PLAZA BEACH HOUSE

GRECOTEL APARTMENTS



**ON THE BEACHFRONT AT THE EASTERN PART  
OF THE PICTURESQUE TOWN OF RETHYMNO.**

Luxurious accommodation with self-catering facilities combined with the comfortable amenities of a resort. The beach is soft sand, the sea Greek blue and kids splash about on paddleboards. Its location in the center of Crete, is ideal to explore all famous sights and the amazing landscape all year round.

# PLAZA BEACH HOUSE

GRECOTEL APARTMENTS



## IDEAL FOR All ages, Families

Open all year round

**LOCATION** Waking distance from Rethymno's town, on the beachfront Rethymnon Old town: 2,5km • Heraklion: 80km • Heraklion Airport: 85km • Chania: 65km • Chania Airport: 72km

**ACCOMMODATION** Total Rooms 84

**BEACH & POOLS** • Long sandy beach with comfortable loungers and beach service. The beach is "Blue Flag" awarded as complying with the directives of the European program. • 1 Sea View Fresh water Main Pool, heated October & April • 1 Fresh water Plaza Pool • 1 half indoor/half outdoor Fresh water Pool • Children paddling fresh water pool

**FEATURES** • 1 Restaurant & 1 bar • Fitness room • Grecoland Kids Snacks Corner (Apr. – Oct.)

**ACTIVITIES** • Sports & Gymnastics • Watersports • Scuba Diving (Apr. – Oct.) • Biking

**AWARDS** • Green & Fair Hotel 2023 by TUI • Bike Friendly Hotel Award 2025-2027 • Plaza Beach House won 18 Awards in 2023 by Travelmyth • Gold Travelife Sustainability in tourism 2024-2026 • Tripadvisor Excellence Award

## MEAL PLANS

**Breakfast** A large variety of breakfast options, ranging from lavish American Buffets to exclusive a la carte options and local specialties. (Apr. – Oct.)

**Family Style breakfast** with a la carte choices (Nov. – Mar.)

**Halfboard** Includes breakfast and buffet dinner at Main Restaurant. Lunch (In exchange of dinner, at the main restaurant).

**All Day a la carte menu** available 11.00 - 22.30 (Nov. – Mar.)

**All Day Bar** available 11.00 - 22.30

## RESTAURANTS & BARS\*

### BREAKFAST

**HOUSE KITCHEN Restaurant** *Buffet Dining.* American Gourmet Buffet with fitness food corner and corner with local products and herb teas. Late Continental Breakfast. Early breakfast service, upon request. In-room breakfast service, on request. (Apr-Oct)

### LUNCH

**HOUSE KITCHEN Restaurant** All-day cuisine at our open-air restaurant. À la carte Menu that incorporates the best of Crete, accented by farm fresh local products. With Extra Charge. Kids' Menus available with extra charge.

### DINNER

**HOUSE KITCHEN Restaurant** Buffet Dining or Set Menu. Mediterranean and local dishes. Enjoy our Roast Local Festive Dinner every Sunday. (Apr-Oct)

**NOTE:** Dining Options includes Breakfast or Half Board. Half Board includes breakfast and dinner in our House Kitchen restaurant (drinks are not included). (Apr-Oct)

\* **From November - March:** Family Style breakfast with a la carte

choices. A la carte menu available 11.00 - 22.30. All day bar. Free in-room coffee & tea facilities.

## BARS

**POOL CLUB VERANDA.** Modern lounges on the terrace for cocktails and refreshments.

## KIDS

**Grecobaby, 0-3 yrs.** Pre-arrival order of baby equipment.

**Grecoland Corner, 4-12 yrs.** 6 times per week, morning. Children under 4 yrs. must be supervised at all times by a parent or guardian. Baby-sitting, extra charge (Apr. – Oct.)

## PLAY HOUSE

Fitness room (All year), pool, Grecoland kids snacks corner and in-house activities for all (Apr. - Oct.).

## RECREATION

*All recreation activities are available depending on seasonality.*

**Gymnastics** Fitness room

**Sports** Table Tennis

**Outside The Hotel** Extra charge: Biking, Water-skiing, Pedal boats, Canoes, Scuba Diving (Apr-Oct), Tennis (nearby, at extra charge)

## MEETINGS

Meeting Facilities with projector and flip charts (Nov. - Mar.)

## ENVIRONMENTAL POLICY

• Use of organic products/produce • Support the protection of the endangered sea turtles Caretta-Caretta

## SERVICES

**WiFi** Free, in all hotel public areas and all guest rooms.

**Grecotel Mobile App** proposes a world of information regarding your stay, online-reservation at the à la carte restaurants and services in and out of the hotel.

**24h WhatsApp Concierge** Designated staff members are at call on WhatsApp, to assist guests on everything they may desire.

**Medical Services** 24hr Medical cover, Doctor on call -extra charges may apply depending on guests' travel insurance. • Pharmacy at 500m • Hospital at 3km

**Transport** Car Rental at the reception • Bus stop at 100m • Taxi Service on request • to Rethymno Old town (2,5km) • to Heraklion (80km) • to Chania (65km)

**Money** All major Credit Cards are accepted. • Nearest Bank/ ATM at 300m

**Voltage** Current 220V.

**Mobility Impaired Guests** The hotel features appropriate types of accommodation for mobility impaired guests. Most departments are accessible by ramp sections next to most of the steps in the hotel.

**Animals** Pets are not allowed due to lack of private gardens. Service animals are allowed to accompany their handler in all hotel premises. View pets policy at grecotel.com/pets-policy

**Official Hotel Categorization** Four star Resort

**Contact details** 60 St Ari Velouhioti, GR-74133 Perivolia, Rethymno, Crete TEL.: (+30) 28310 51505 E-mail: reservations.pz@grecotel.com



## PLAZA BEACH HOUSE HOTEL MAP

- 1. Entrance
- 2. Reception
- 3. Spa Lounges
- 4. Plaza Restaurant
- 5. Sunset Pool Café
- 6. TV Corner
- 7. Main Pool
- 8. Plaza Pool
- 9. Plaza Spa
- 10. Spa Pool
- 11. Grecoland
- 12. Children's Pool
- 13. Hotel Beach

## ACCOMMODATION CHART

ROOM TYPES	LOCATION	SIZE	SLEEPS	VIEW
Plaza Studio	Ground/1st floor	31-42m <sup>2</sup>	3 or 2 + 1	Garden
Plaza Studio Sea View	Ground/1st floor	31-42m <sup>2</sup>	3 or 2 + 1	Sea View
Superior Plaza Apartment	Ground/1st floor	38-43m <sup>2</sup>	2+2 or 3+1	Garden
Family Apartment	Ground/1st floor	38-43 m <sup>2</sup>	2+2 or 3+1	Garden
Petit Loft Maisonette	1st floor	41 m <sup>2</sup>	2+2 or 3+1	Garden
Master Loft Maisonette	1st floor	41-63m <sup>2</sup>	2+2 or 3+1	Garden
Sea View Apartment	Ground/1st floor	38-43m <sup>2</sup>	2+2 or 3+1	Direct Sea
Loft 2 Bedroom Maisonette	1st floor	62-97m <sup>2</sup>	4+1	Garden
Plaza Grande Apartment	Ground/1st floor	62-97m <sup>2</sup>	6	Garden
Family Apartment with pool	Ground floor	38-43m <sup>2</sup>	2+2 or 3+1	Garden
"Fortezza" Apartment, Direct Sea View	1st floor	80m <sup>2</sup>	5	Direct Sea
"Città vecchia" Apartment, by the pool	Ground floor	63m <sup>2</sup>	4+1	Direct Sea

### All room types include:

- In-room safe
- Refrigerator
- Room service
- Luxurious beds & linens
- Hairdryer
- Beach towels
- Bathroom amenities
- Satellite TV



## PLAZA STUDIO GARDEN VIEW

**Location:** Ground floor /1st floor

**View:** Garden View

**Size:** Indoor: 31-42 sq.m.,

**Layout:** Split-level

**Sleeps:** 3 Adults or 2 Adults + 1 Child

**Beds:** Double bed & single bed

**Bath:** Bathroom with bathtub



ACCOMMODATION LAYOUTS & PHOTOS ARE SAMPLES AND MAY VARY DEPENDING ON THE POSITION WITHIN THE HOTEL. MEASUREMENTS ARE APPROXIMATE TO THE NEAREST m<sup>2</sup>

**View more details & photos about facilities, services & room details online at [plazabeachhouse@grecotel.com](mailto:plazabeachhouse@grecotel.com)**





## PLAZA STUDIO SEA VIEW

**Location:** Ground/1st floor

**View:** Sea View

**Size:** Indoor: 31-42 sq.m.,

**Layout:** One level or Split-level

**Sleeps:** 3 Adults or 2 Adults + 1 Child

**Beds:** Double bed & single bed

**Bath:** Bathroom with bathtub or shower



## SUPERIOR PLAZA APARTMENT GARDEN VIEW

**Location:** Ground floor or 1st floor

**View:** Garden View

**Size:** Indoor: 38-43 sq.m.

**Layout:** Separate rooms, Master bedroom and living/2nd sleeping area

**Sleeps:** 2+2 or 3+1

**Beds:** 1 King Size bed & sofa bed

**Bath:** Bathroom with bathtub



## FAMILY APARTMENT GARDEN VIEW

**Location:** Ground/1st floor

**View:** Garden

**Size:** Indoor: 38-43 sq.m.

**Layout:** Separate rooms, Master bedroom and dining/living/2nd sleeping area with kitchenette

**Sleeps:** 2+2 or 3+1

**Beds:** King Size bed & bunk beds

**Bath:** Bathroom with bathtub





## PETIT LOFT MAISONETTE

### GARDEN VIEW

**Location:** 1st floor

**View:** Garden View

**Size:** Indoor: 41 sq.m.,

**Layout:** Split-level. Entrance level: Lounge & 2nd sleeping area, dining area with kitchen. Top floor: Master bedroom

**Sleeps:** 2+2 or 3+1

**Beds:** King Size bed & bunk beds

**Bath:** Entrance level: Bathroom with shower (selected rooms). Top floor: Bathroom with bathtub or hydro-massage (selected rooms)

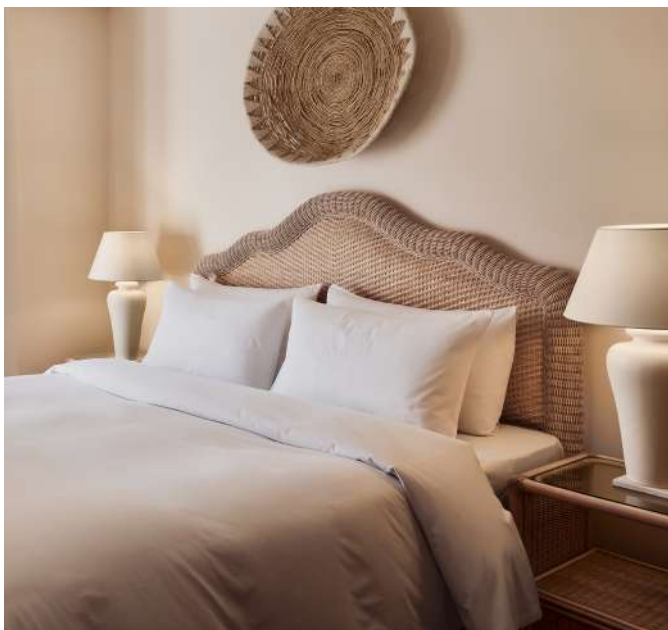

## MASTER LOFT MAISONETTE

### GARDEN

**Location:** 1st floor **View:** Garden View **Size:** Indoor: 41-63 sq.m.,

**Layout:** Split-level. Entrance level: Lounge & 2nd sleeping area, dining area with kitchen. Top floor: Master bedroom suite

**Sleeps:** 2+2 or 3+1

**Beds:** King size bed & sofa or twin beds or bunk beds

**Bath:** Entrance level: Bathroom with shower (selected rooms).

**Top floor:** Bathroom with bathtub or hydro-massage (selected rooms)



## SEA VIEW APARTMENT

### DIRECT SEA VIEW

**Location:** Ground/1st floor **View:** Direct Sea View

**Size:** Indoor: 38-43 sq.m. **Layout:** Separate rooms, Master bedroom and dining/living/2nd sleeping area with kitchenette

**Sleeps:** 2+2 or 3+1

**Beds:** King Size bed & twin beds or bunk beds

**Bath:** Bathroom with bathtub or hydro-massage (selected rooms)

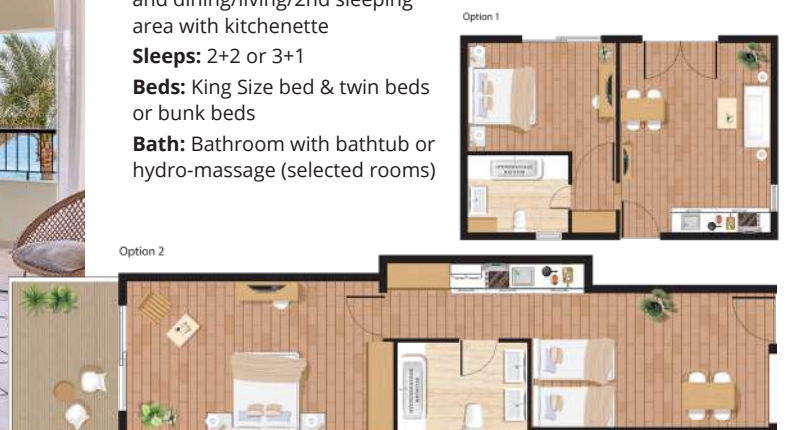





## LOFT 2 BEDROOM MAISONETTE GARDEN VIEW

**Location:** 1st floor **View:** Garden View **Size:** Indoor: 62-97 sq.m.

**Layout:** Split-level. Separate rooms. 2 master bedroom suites and a spacious living/dining/2nd sleeping area with kitchen **Sleeps:** 4+1 **Beds:** 1 king-size bed and twin beds or bunk beds **Bath:** Entrance level: bathtub or shower Top level: bathtub (some with hydro-massage)



## PLAZA GRANDE APARTMENT GARDEN VIEW

**Location:** Ground/1st floor **View:** Garden View **Size:** Indoor: 62-97 sq.m.,

**Layout:** 2 master bedroom suites and a spacious living/dining/2nd sleeping area with kitchen. **Sleeps:** 6 **Beds:** One level layout: 2 King size beds (or 1 King Size and twin beds) & bunk beds. Maisonette layout: 1 king-size bed and twin beds or & bunk beds **Bath:** One level layout: 2 bathrooms, one with bathtub and one with hydro-massage. Maisonette layout: Entrance level: bathtub or shower. Top level: bathtub (some with hydro-massage)



## FAMILY APARTMENT WITH POOL GARDEN VIEW

**Location:** Ground floor

**View:** Garden View

**Size:** Indoor: 38-43 sq.m.,

**Layout:** Separate rooms, Master bedroom and dining/living/2nd sleeping area with kitchenette

**Sleeps:** 2+2 or 3+1

**Beds:** King Size bed, bunk beds

**Bath:** Bathroom with hydro-massage



## “FORTEZZA” APARTMENT

DIRECT SEA VIEW

**Location:** 1st floor

**View:** Direct Sea View

**Size:** Indoor: 80 sq.m.

**Layout:** Split level. 2 Separate master bedrooms and a spacious living/dining/area with kichenette.

**Sleeps:** 5

**Beds:** 2 King size beds, 1 single bed

**Bath:** 1 bathroom with bathtub. 2 bathrooms with shower

Entrance level



Upper floor



## “CITTÀ VECCHIA” APARTMENT BY THE POOL

DIRECT SEA VIEW

**Location:** Ground Floor **View:** Direct Sea View

**Size:** Indoor: 63 sq.m.

**Layout:** Separate rooms, Master bedroom and dining/living/2nd sleeping area

**Sleeps:** 4+1

**Beds:** 2 King size beds, 1 single bed

**Bath:** 1 Bathroom with bathtub & 1 bathroom with shower

